

# USER MANUAL

## PHACON NEURO ASSISTANT

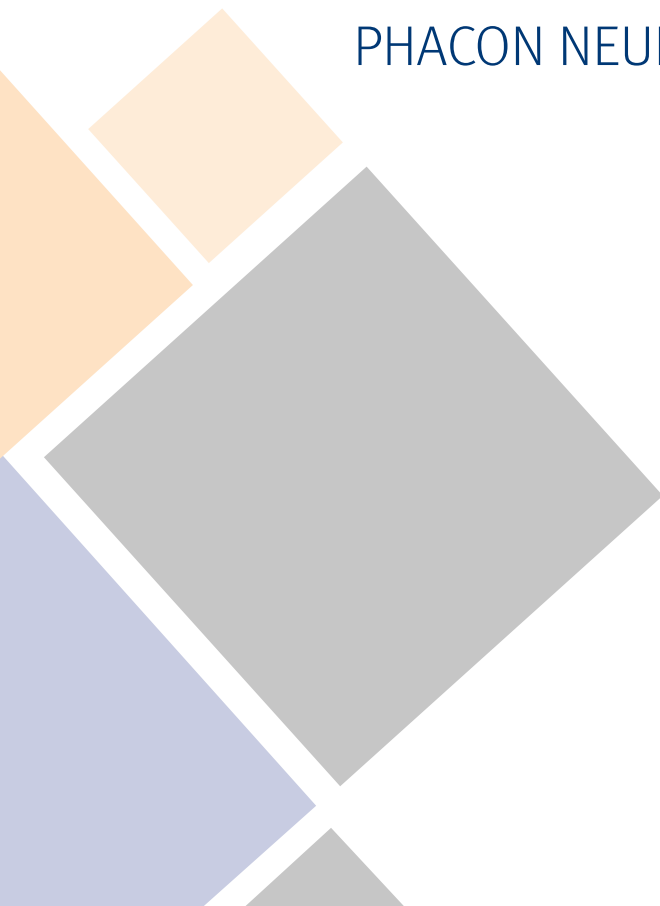

# INSTRUCTIONS

## INTENDED USE

The PHACON Neuro Assistant is intended to be used by healthcare professionals for education and training purposes only. The assistant allows surgical residents and other healthcare professionals to use actual surgical instruments on three dimensional (3-D) anatomical models.

If you are not sure whether parts are damaged or faulty, or if you have any questions regarding the use, please contact PHACON Support (Phone: +49 (0)341 47 83 97 32 or support@phacon.de) in immediately.

## USER SAFETY



### WARNINGS:

- Only trained and experienced healthcare professionals should use this equipment. Before using any system component, or any component compatible with this assistant, read and understand the instructions. Become familiar with the assistant components prior to use.
- Upon initial receipt and before each use, operate the equipment and inspect each component for damage. DO NOT use any component if damage is apparent. See the care / cleaning instructions section.

NOTE: If you need more information:

Phone: +49 (0)341 47 83 97 32

Mail: support@phacon.de



### OTHER GENERAL WARNINGS

Always use your surgical instruments according to the intended use of the manufacturer.

### Cases and packaging

#### WARNINGS:

The suitcase and the packaging foils are not toys and not suitable for children. There is a risk of suffocation! The packaging material is not suitable for eating. Packaging waste is not to be disposed of via normal household waste. Please think about your environment. Please do not use any liquid food or drink during use.

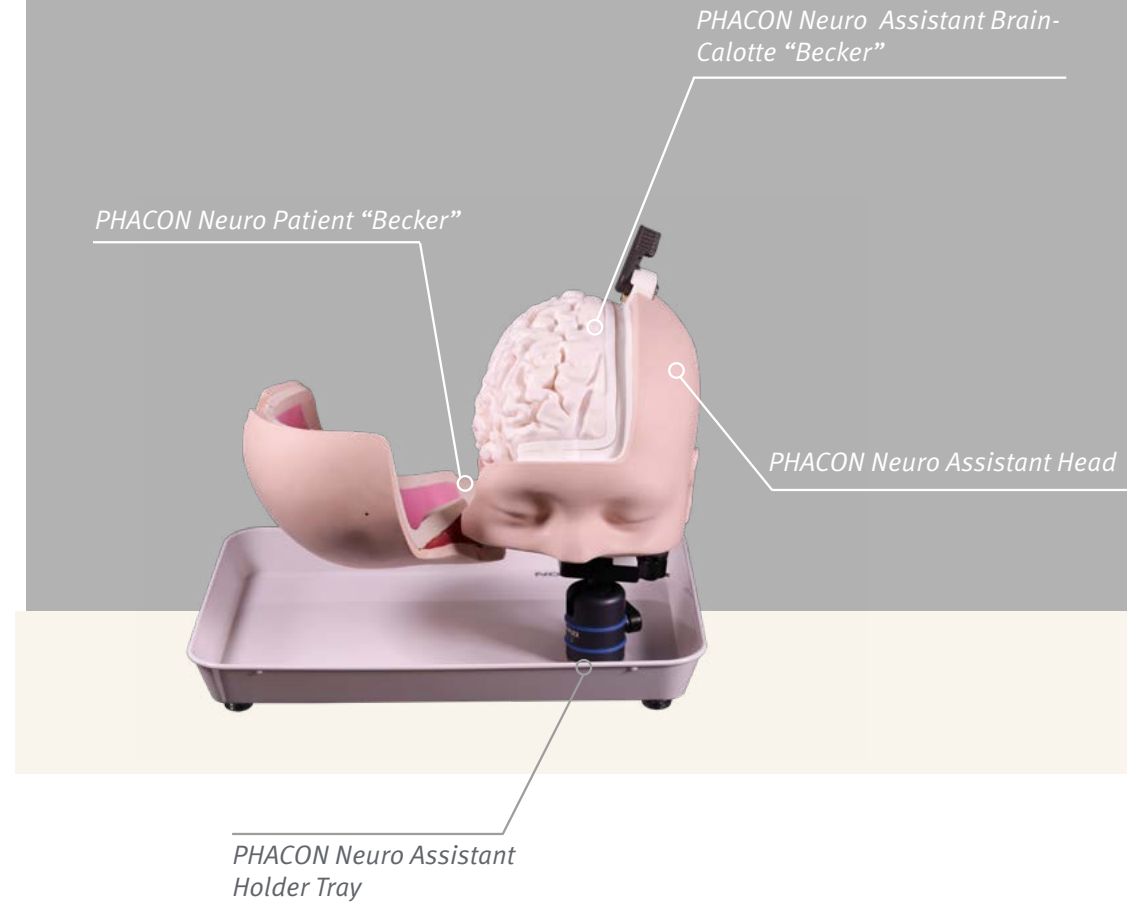

DISCOVER THE INTRODUCTION  
IN OUR PHACON NEURO ASSISTANT

## PACKING INSTRUCTIONS

### PHACON NEURO ASSISTANT - TRANSPORT CASE

**1.** First place the brochure in the recess



**2.** Second insert the holder tray into the recess.



**3.** Insert the head into the right side of the tray.



**4.** Finally, place the foam to protect the contents on the models so that the recess shows the head model. Close the case carefully and lock it.



## NEURO ASSISTANT COMPONENTS

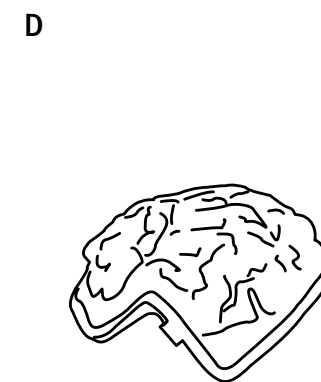
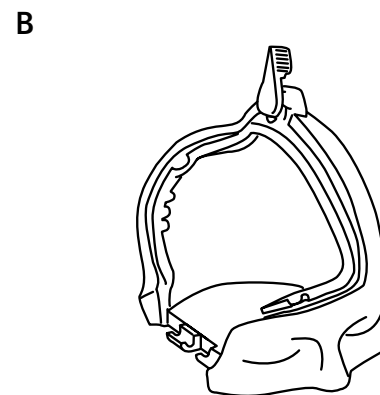
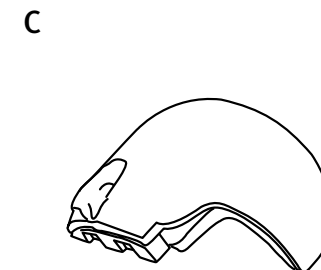
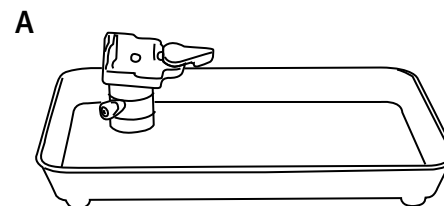

*A Holder Tray*

*B PHACON Neuro Assistant Head*

*C PHACON Neuro Patient "Becker"*

*D PHACON Neuro Assistant Brain-Calotte "Becker"*

## INSTRUCTIONS

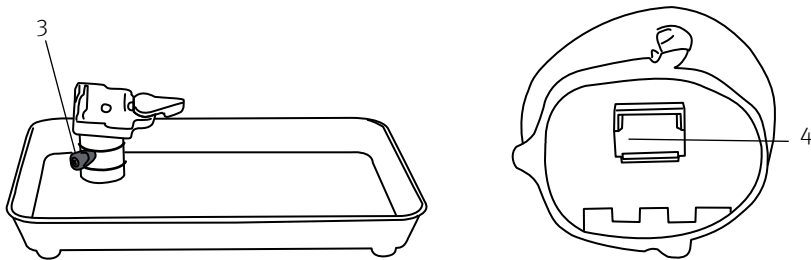

### Holder Tray

First you fix the mounting plate, for this the ball head is brought into the desired position. Now tighten the swivel switch counterclockwise.

### TIP:

Make sure to fasten it properly to prevent it from falling over

### 1. Locking lever

Release to attach the head.

### 2. Mounting plate

The head plate for mounting in the  
Slide the base in.

### 3. Swivel switch

For adjusting the head position. Tighten to lock the head.

### 4. Head plate

The mounting plate is located at the back of the Neuro Assistant head.

## INSTRUCTIONS

Image 1

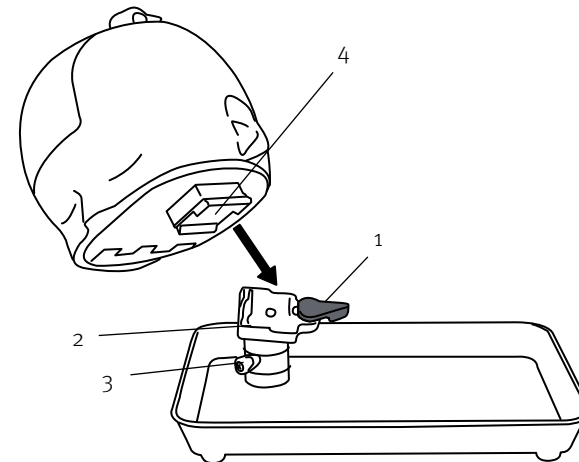

### Fasten the head to the holding shell

**Image 1** Turn the locking lever on the mounting plate base of the holding shell to the left.

Slide in the plate of the head.

Close the locking lever of the mounting plate to the right again.

Open the locking lever to the left.

Image 2

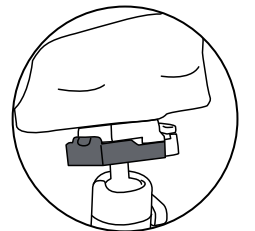
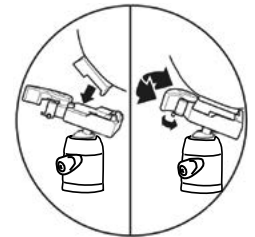

Correctly Closed

## INSTRUCTIONS

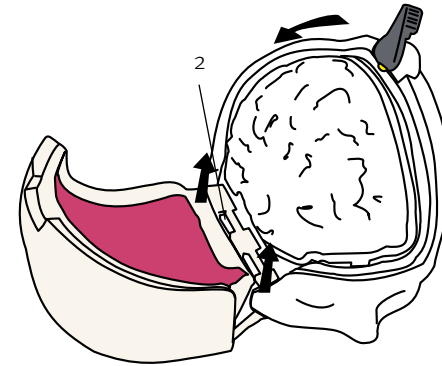
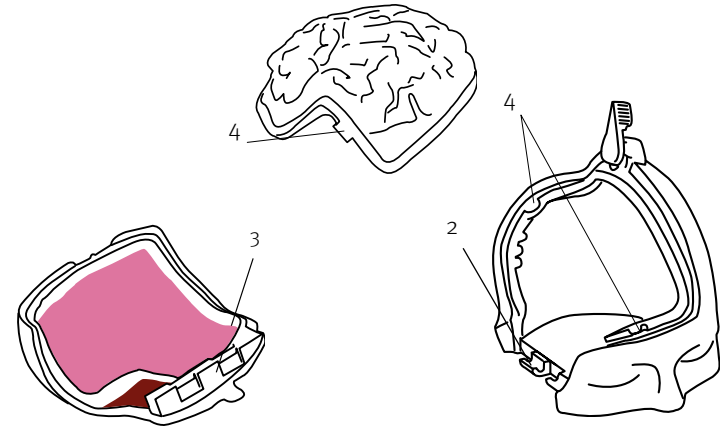
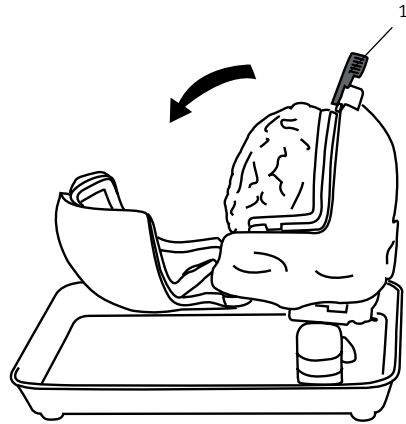
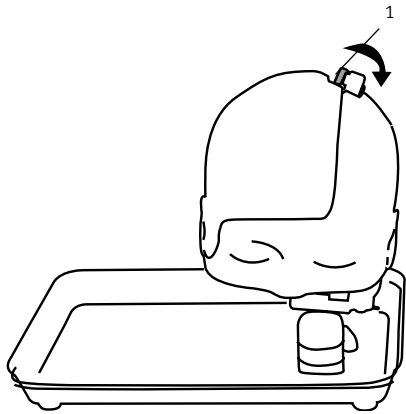

### Open/Close Neuro Patient Head

To open the skullcap, you must first turn the (1) locking lever of the head clockwise to the top. Then you can carefully guide the skullcap downwards.

For closing the skullcap bring it in the upper position and close the (1) locking lever by turning down.

### Neuro Patient „Becker“ remove/insert

To remove the skullcap, simply grasp it carefully from below and lift it upwards out of the (2) support rails. To insert the (3) holder back into the holder rails.

### Remove PHACON Neuro Assistant Brain-Calotte “Becker”

You can grip it with your hand and turn it slightly to the left. You can easily reinsert it by using the (4) position markers.

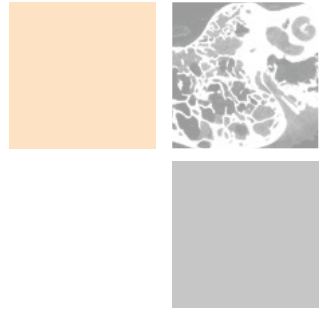

# THE PATIENTS FOR YOUR SURGICAL DEMONSTRATION AND EDUCATION

## EUROPE

---

### **PHACON GmbH**

Druckereistrasse 11  
04159 Leipzig  
Germany

[www.phacon.de](http://www.phacon.de)

Phone: +49 (0)3 41 47 83 97 32  
Fax: +49 (0)3 41 47 83 91 74  
Mail: [info@phacon.de](mailto:info@phacon.de)

## USA

---

### **PHACON Inc.**

4470 Chamblee-Dunwoody Rd. /// Suite 463  
Dunwoody /// GA 30338 /// USA

[www.phacon.us](http://www.phacon.us)

Phone: 1 833 2 PHACON  
2 742266  
Fax: 470 243 0494  
Mail: [info@phacon.us](mailto:info@phacon.us)